

HYDRAULIC-TYPE FORCE MEASURING DEVICE

Model SIMPLEX II

Load cells for static and dynamic force measurements, **extremely compact design**, indicator Ø 63 mm, measuring range and dimensions as in data table.

Special advantages of this model:

Measurability starts at zero, temperature resistance between -20°C and + 70°C, high exposure frequency.

- > Standard design with maximum drag indicator = accuracy $\pm 2\%$ of scale end value and throttle damping for slightly abrupt load and unload.
- > Comes with an ISO 9001 compliant factory test certificate.
- > Transporting box included.
- > [See page 2 for the digital-indicator design.](#)

All accessories included in base price.

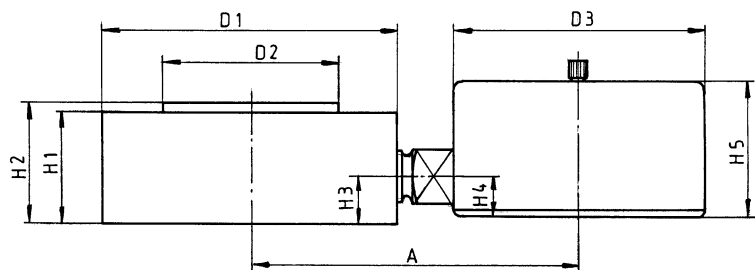

Data table

Assembly group 01														
Measuring range	N/kN	160	250	400	600	1	1,6	2,5	4	6	10	16	25	40
Scale division	N/kN	5	10	20	20	0,05	0,05	0,1	0,2	0,2	0,5	0,5	1	2
Cell`s outer- Ø D1	mm	75	75	75	75	75	75	75	75	75	75	75	75	75
Piston- Ø D2	mm	45	45	45	45	45	45	45	45	45	45	45	45	45
Height H1/H2	mm	28/30	28/30	28/30	28/30	28/30	28/30	28/30	28/30	28/30	28/30	28/30	28/30	28/30
Height H3/H4	mm	12/10	12/10	12/10	12/10	12/10	12/10	12/10	12/10	12/10	12/10	12/10	12/10	12/10
Height H5	mm	36	36	36	36	36	36	36	36	36	36	36	36	36
Spacing A	mm	82	82	82	82	82	82	82	82	82	82	82	82	82
Manometer- Ø D3	mm	63	63	63	63	63	63	63	63	63	63	63	63	63

Assembly group 02				Assembly group 03					
Measuring range	kN	60	100	Measuring range	kN	160	250	400	600
Scale division	kN	2	5	Scale division	kN	5	10	20	20
Cell`s outer- Ø D1	mm	90	90	Cell`s outer- Ø D1	mm	145	145	145	145
Piston- Ø D2	mm	56	56	Piston- Ø D2	mm	89	89	89	89
Height H1/H2	mm	30/32	30/32	Height H1/H2	mm	36/38	36/38	36/38	36/38
Height H3/H4	mm	12/10	12/10	Height H3/H4	mm	18/10	18/10	18/17	18/17
Height H5	mm	36	36	Height H5	mm	36	36	45	45
Spacing A	mm	90	90	Spacing A	mm	118	118	118	118
Manometer- Ø D3	mm	63	63	Manometer- Ø D3	mm	63	63	63	63

Model SIMPLEX II with digital indicator

- > Digital manometer NG 74 mm
- > Displaying range 160 N to 600 kN
- > Measurability starts at 1% of end value
- > 4-digit LCD display
- > Digit height 12.7 mm
- > Powered by a 9V block battery
- > Measuring accuracy from 1 kN = 0,5 % of end value
- > Displaying range at 160 to 600 N currently a further 1 % of end value
- > Peak value memory
- > Optional: limiter relay / Schließer, analogue output 0 – 2 V

A 350° rotatable front panel makes sure the display is always conveniently readable, regardless of mounting position.

Additionally, the device housing can be axially rotated in any way desired by loosening the locknut on the process connection.

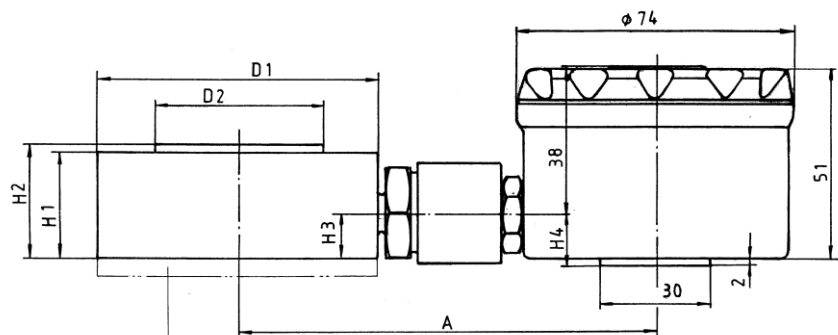

Compensation shim, 5mm thick, required unless the gauge is exposed when loaded

* Optional: with compensation shim, for an extra charge

Assembly group 01											
Measuring range	N/kN	0-160	0-250	0-400	0-600	0-1	0-1,6	0-2,5	0-4	0-6	0-10
Resolution	N/kN	0,1	0,1	0,1	0,1	0,001	0,001	0,001	0,001	0,001	0,01
Cell's outer-ø D1	mm	75	75	75	75	75	75	75	75	75	75
Piston ø D2	mm	45	45	45	45	45	45	45	45	45	45
Height H1/H2	mm	28/30	28/30	28/30	28/30	28/30	28/30	28/30	28/30	28/30	28/30
Height H3/H4	mm	12/15,5	12/15,5	12/15,5	12/15,5	12/15,5	12/15,5	12/15,5	12/15,5	12/15,5	12/15,5
Spacing A	mm	111	111	111	111	111	111	111	111	111	111
Assembly group 01				Assembly group 02			Assembly group 03				
Measuring range	kN	0-16	0-25	0-40	0-60	0-100	0-160	0-250	0-400	0-600	
Resolution	kN	0,01	0,01	0,01	0,01	0,1	0,1	0,1	0,1	0,1	
Cell's outer-ø D1	mm	75	75	75	90	90	145	145	145	145	
Piston ø D2	mm	45	45	45	56	56	89	89	89	89	
Height H1/H2	mm	28/30	28/30	28/30	30/32	30/32	36/38	36/38	36/38	36/38	
Height H3/H4	mm	12/15,5	12/15,5	12/15,5	12/15,5	12/15,5	18/15,5	18/15,5	18/15,5	18/15,5	
Spacing A	mm	111	111	111	118	118	146	146	146	146	

Technical modification excepted.

As of 09.05.2018